

unimotion  
Bus stop

Student Information & Advice Centre  
RECEPTION

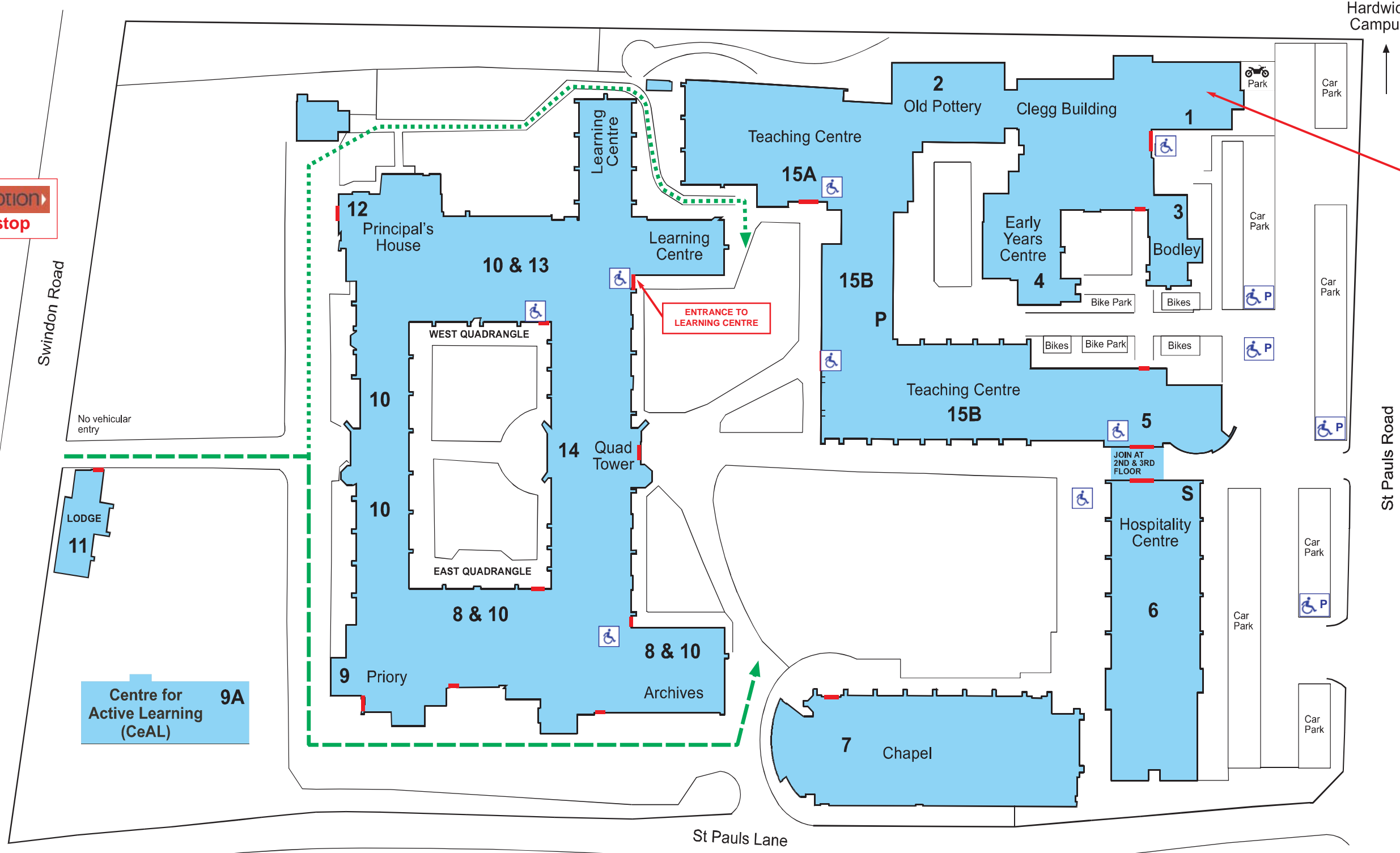

- |  |  |  |  |  |
|--|--|--|--|--|
| <p><b>1 CLEGG BUILDING (CL)</b><br/>Campus Reception CL017<br/>Finance Officer CL018<br/>Campus Administrators CL019<br/>SIAC Officer CL021<br/>Campus Resources Manager CL023<br/>Environment Staff (All Floors)<br/>Campus Administration Manager CL118 (First Floor)<br/>Campus Dean &amp; Administration Staff (First Floor)<br/>Teaching Rooms: CL009, CL060, CL061b, CL103, CL132 (First Floor)<br/>Studios: Blue Studio CL220, Green Studio CL253 (Second Floor)</p> <p><b>2 CLEGG OLD POTTERY (CL)</b><br/>Environment Staff (CL050a - CL058)<br/>Centre for Local Policy (CL051)</p> <p><b>3 BODLEY BUILDING (BO)</b><br/>Student Services (BO001 - BO201a)</p> | <p><b>4 CLEGG EARLY YEARS CENTRE CL061a (CL)</b><br/>CL061c Office - Education Staff</p> <p><b>5 HOSPITALITY CENTRE (HC)</b><br/>Students' Union Substation TC008<br/>Students' Union Bar (First Floor)</p> <p><b>6 HOSPITALITY CENTRE (HC)</b><br/>Security Lodge<br/>Refractory (Cheltenham Suite)<br/>Teaching Rooms HC201 - 207 (Second Floor)<br/>Gloucester Suite Restaurant (Third Floor)</p> <p><b>7 CHAPEL OF ST MARY &amp; ST PAUL</b></p> <p><b>8 QUAD EAST (QU)</b><br/>Learning Centre<br/>Archives<br/>QU027 Laboratory<br/>Environment Staff (First Floor)<br/>QU109 Laboratory (First Floor)</p> | <p><b>8 QUAD EAST (Continued)</b><br/>Humanities &amp; Environment Staff (Second Floor)<br/>QU210 Laboratory (Second Floor)</p> <p><b>9A CENTRE FOR ACTIVE LEARNING (CeAL)</b></p> <p><b>9 PRIORY (QU)</b><br/>Postgraduate Research Students<br/>Centre for Active Learning (CeAL) Staff (First Floor)<br/>Humanities Staff (Second Floor)</p> <p><b>10 QUAD EAST (QU)</b><br/>Learning Centre</p> <p><b>11 LODGE (LO)</b><br/>Playwork Partnerships &amp; EQUIPE Project</p> <p><b>12 PRINCIPAL'S HOUSE (PH)</b><br/>Learning Centre</p> | <p><b>13</b> Education Staff (First Floor)<br/>Humanities &amp; WEMTC Staff (Second Floor)<br/><b>QUAD WEST (QW)</b><br/>Learning Centre<br/>Education &amp; Social Sciences Staff (First Floor)<br/>Humanities, Education, WEMTC &amp; JRI Staff (Second Floor)<br/>Seminar Room QW215 (Second Floor)</p> <p><b>14 QUAD TOWER (QT)</b><br/>School of Education Offices QT101 - QT202 (First and Second Floors)</p> <p><b>15A TEACHING CENTRE (TC)</b><br/>Lecture Rooms TC001 - TC003<br/>Resources TC002a (AV Unit)<br/>Cleaning Supervisor TC002b (Lost Property)</p> | <p><b>15B</b> Teaching Laboratories TC101 - 108 (First Floor)</p> <p><b>TEACHING CENTRE (TC)</b><br/>Porters &amp; Maintenance Staff (Magnolia Court Basement)<br/>Careers TC004/5<br/>Lecture Rooms TC006, TC007 &amp; TC009<br/>Students' Union Substation TC008<br/>IT Suite TC114 (First Floor)</p> <p><b>S</b> Security</p> <p><b>P</b> Porters</p> <p><b>1</b> Student Information &amp; Advice Centre<br/>RECEPTION</p> |
|--|--|--|--|--|

----- Pedestrian/Disabled Access

..... Pedestrian Access

Disabled Access

Disabled Parking